

DIMENSIONS

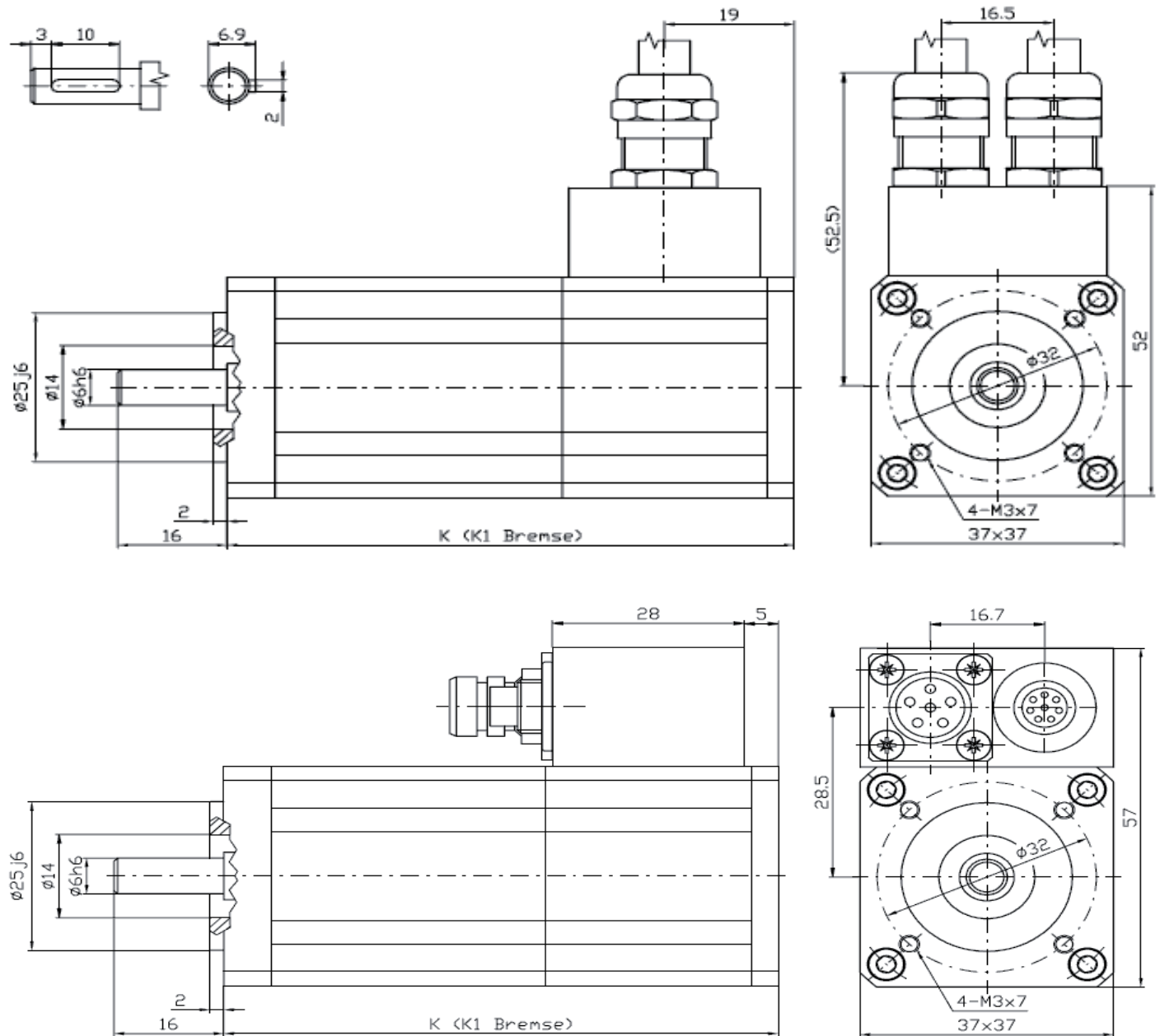

Type	K	K1 (brake)
SMXN1-010	81 mm	111 mm
SMXN1-020	96 mm	126 mm
SMXN1-030	111 mm	141 mm

On request we can send you the technical parameters of the motors designed for different DC-Voltages or speed/torque characteristics. Other adaptations and modifications are possible.

TECHNICAL DATA

		VDC	36				320			
Magnets Nd-Fe-B			SMXN2-28	SMXN2-54	SMXN2-75	SMXN2-95	SMXN2-28	SMXN2-54	SMXN2-75	SMXN2-95
Stall torque	M_0	Nm	0,28	0,54	0,75	0,95	0,28	0,54	0,75	0,95
Stall current	I_0	A	7,9	7,6	7,7	7,3	0,97	1,17	1,54	1,82
Nominal torque	M_N	Nm	0,25	0,51	0,72	0,93	0,25	0,48	0,68	0,85
Nominal speed	n_N	min. ⁻¹	4000	3000	2500	1500	4500	4500	4500	4500
Nominal power	P_N	W	104	160	188	146	117	226	320	400
Nominal current	I_N	A	7,8	7,77	7,8	7,5	0,96	1,12	1,48	1,7
Maximum torque	M_{max}	Nm	1,1	2,1	2,7	3,1	1,1	2,2	3	3,8
Maximum current	I_{max}	A	36	33	31	25	4,5	5,4	7,1	8,4
Max. speed mech.	n_{max}	min. ⁻¹	12000	12000	12000	12000	12000	12000	12000	12000
Torque constant	K_M	Nm/A	0,04	0,07	0,1	0,13	0,29	0,46	0,49	0,52
Voltage constant	K_E	V/1000	2,2	4,3	5,9	7,8	17,5	28	29,5	31,5
Motor poles	2p	-	6	6	6	6	6	6	6	6
Resistance 2 ph.	R_{2Ph}	Ω	0,43	0,62	0,66	0,82	28,3	25,9	17	13,1
Inductance 2 ph.	L_{2Ph}	mH	0,42	0,76	0,89	1,18	28,4	32,3	22,7	19
Inertia	J	kgcm ²	0,05	0,07	0,09	0,11	0,05	0,07	0,09	0,11
Mass without brake	m	kg	0,76	0,93	1,1	1,27	0,76	0,93	1,1	1,27
Mass with brake	m_{Br}	kg	1,2	1,37	1,54	1,71	1,2	1,37	1,54	1,71
Brake torque	M_{Br}	Nm	2	2	2	2	2	2	2	2

		VDC	560			
Magnets Nd-Fe-B			SMXN2-28	SMXN2-54	SMXN2-75	SMXN2-95
Stall torque	M_0	Nm	0,28	0,54	0,75	0,95
Stall current	I_0	A	0,97	0,93	0,86	1,15
Nominal torque	M_N	Nm	0,25	0,48	0,68	0,85
Nominal speed	n_N	min. ⁻¹	4500	4500	4500	4500
Nominal power	P_N	W	117	226	320	400
Nominal current	I_N	A	0,96	0,9	0,83	1,07
Maximum torque	M_{max}	Nm	1,1	2,2	3	3,8
Maximum current	I_{max}	A	4,5	4,3	3,9	5,3
Max. speed mech.	n_{max}	min. ⁻¹	12000	12000	12000	12000
Torque constant	K_M	Nm/A	0,29	0,58	0,88	0,83
Voltage constant	K_E	V/1000	17,5	35	53	50
		rpm	6	6	6	6
Motor poles	2p	-	28,3	41,1	54	33,6
Resistance 2 ph.	R_{2Ph}	Ω	28,4	51	72	48,5
Inductance 2 ph.	L_{2Ph}	mH	0,05	0,07	0,09	0,11
Inertia	J	kgcm ²	0,76	0,93	1,1	1,27
Mass without brake	m	kg	1,2	1,37	1,54	1,71
Mass with brake	m_{Br}	kg				
Brake torque	M_{Br}	Nm				

SERVOMOTORS SMXN2

0.28-0.95 Nm

DIMENSIONS

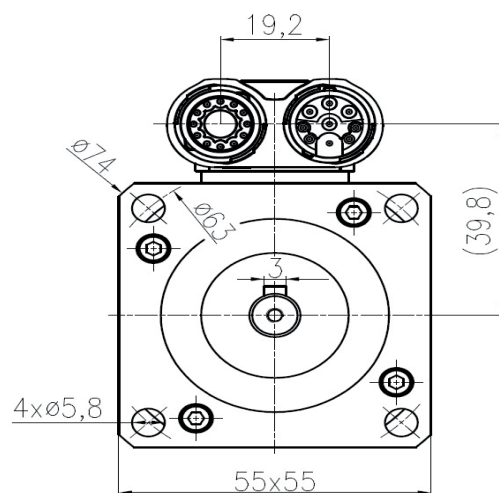
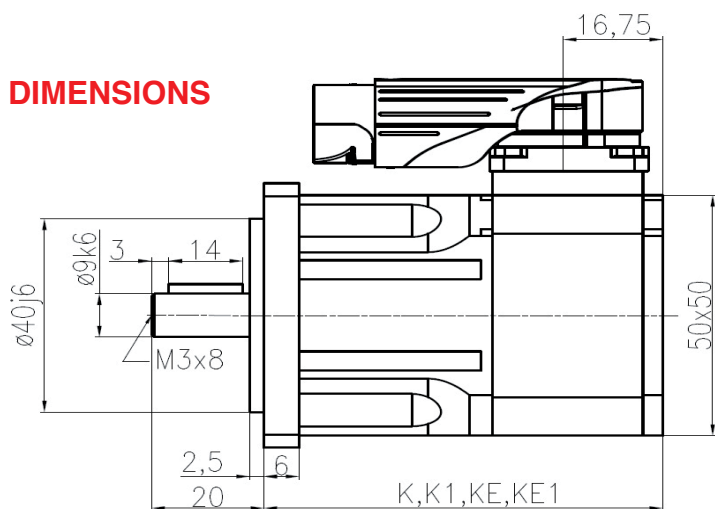

Type	K (Resolver)	K1 (Resolver+brake)	KE (EnDAT)	KE1 (EnDAT+brake)
SMXN2-028	67 mm	105 mm	131 mm	166 mm
SMXN2-054	82 mm	120 mm	146 mm	181 mm
SMXN2-075	97 mm	135 mm	161 mm	196 mm
SMXN2-095	112 mm	150 mm	176 mm	211 mm

Length of motor with Hiperface sensor is the same like legth of motor with EnDat sensor. In some types of motor can be smaller.

Servomotors with one integrated connector

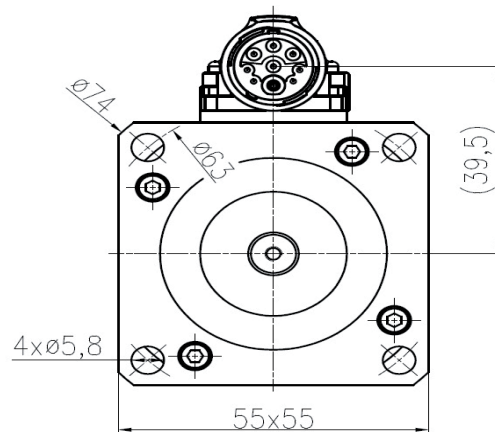
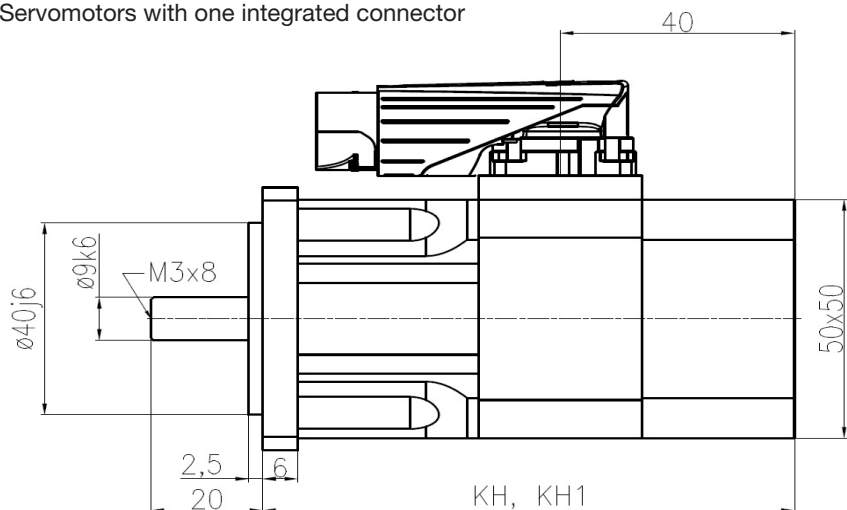

Type	KH (DSL)	KH1 (DSL+brake)
SMXN2-028	94 mm	128 mm
SMXN2-054	109 mm	143 mm
SMXN2-075	124 mm	158 mm
SMXN2-095	139 mm	173 mm

On request we can send you the technical parameters of the motors designed for different DC-Voltages or speed/torque characteristics. Other adaptations and modifications are possible.

TECHNICAL DATA

		VDC	320				
Magnets Nd-Fe-B			SMXN2.5-75	SMXN2.5-130	SMXN2.5-175	SMXN2.5-220	SMXN2.5-300
Stall torque	M_0	Nm	0,75	1,3	1,75	2,2	3
Stall current	I_0	A	1,87	3	3,07	3,2	3,7
Nominal torque	M_N	Nm	0,43	0,78	1,03	1,23	1,49
Nominal speed	n_N	min. ⁻¹	7500	6000	5000	4500	4000
Nominal power	P_N	W	337	490	539	579	624
Nominal current	I_N	A	1,73	2	2	2	2,1
Maximum torque	M_{max}	Nm	2,47	4,9	6,7	8,4	11,4
Maximum current	I_{max}	A	7,69	14,3	13,6	14,2	15,9
Max. speed mech.	n_{max}	min. ⁻¹	12000	12000	12000	12000	12000
Torque constant	K_M	Nm/A	0,4	0,43	0,57	0,68	0,81
Voltage constant	K_E	V/1000 min. ⁻¹	24,2	26	34,5	41	49
Motor poles	2p	-	10	10	10	10	10
Resistance 2 ph.	R_{2Ph}	Ω	6,63	3	3,2	3,3	2,9
Inductance 2 ph.	L_{2Ph}	mH	7,45	4,3	5	5,4	5,1
Inertia	J	kgcm ²	0,33	0,5	0,68	0,85	1,2
Mass without brake	m	kg	1,3	1,6	1,9	2,2	2,8
Mass with brake	m_{Br}	kg	1,8	2,1	2,4	2,7	3,3
Brake torque	M_{Br}	Nm	2	2	2	2	2

		VDC	560				
Magnets Nd-Fe-B			SMXN2.5-75	SMXN2.5-130	SMXN2.5-175	SMXN2.5-220	SMXN2.5-300
Stall torque	M_0	Nm	0,75	1,3	1,75	2,2	3
Stall current	I_0	A	1,24	1,91	1,71	1,96	2,93
Nominal torque	M_N	Nm	0,43	0,78	1,03	1,23	1,49
Nominal speed	n_N	min. ⁻¹	7500	6000	5000	4500	4000
Nominal power	P_N	W	337	490	539	579	624
Nominal current	I_N	A	0,8	1,64	1,36	1,44	1,87
Maximum torque	M_{max}	Nm	2,47	4,94	6,65	8,36	11,4
Maximum current	I_{max}	A	5,1	9,05	7,56	8,55	12,6
Max. speed mech.	n_{max}	min. ⁻¹	12000	12000	12000	12000	12000
Torque constant	K_M	Nm/A	0,6	0,68	1,02	1,12	1,02
Voltage constant	K_E	V/1000 min. ⁻¹	36,5	41,2	61,8	67,9	61,8
Motor poles	2p	-	10	10	10	10	10
Resistance 2 ph.	R_{2Ph}	Ω	15	7,48	10,17	8,74	4,56
Inductance 2 ph.	L_{2Ph}	mH	16,7	10,75	16,12	14,6	8,06
Inertia	J	kgcm ²	0,33	0,5	0,68	0,85	1,2
Mass without brake	m	kg	1,3	1,6	1,9	2,2	2,8
Mass with brake	m_{Br}	kg	1,8	2,1	2,4	2,7	3,3
Brake torque	M_{Br}	Nm	2	2	2	2	2

DIMENSIONS

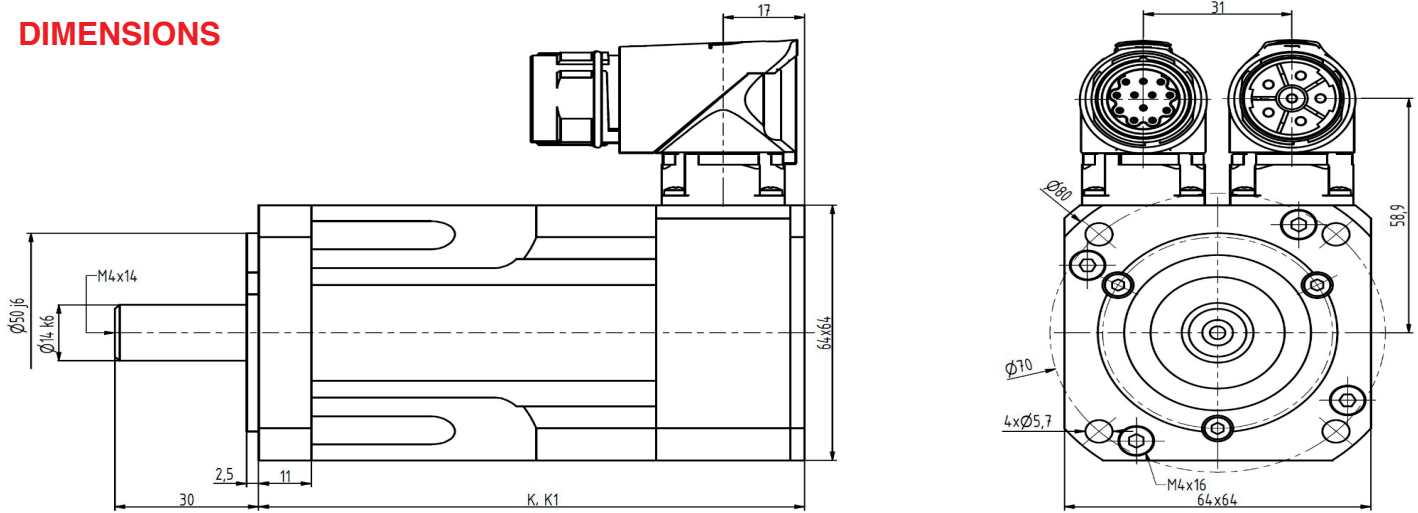

Type	K (Resolver)	K1 (Resolver+brake)
SMXN2.5-075	96 mm	138 mm
SMXN2.5-130	114 mm	156 mm
SMXN2.5-175	132 mm	174 mm
SMXN2.5-220	150 mm	192 mm
SMXN2.5-300	186 mm	228 mm

Information about motor with Hiperface or EnDat feedback sensor on demand.

On request we can send you the technical parameters of the motors designed for different DC-Voltages or speed/torque characteristics. Other adaptations and modifications are possible.

TECHNICAL DATA

		VDC	36		320			
Magnets Nd-Fe-B			SMXN3-115	SMXN3-205	SMXN3-115	SMX3-205	SMXN3-350	SMXN3-480
Stall torque	M_0	Nm	1,15	2,05	1,15	2,05	3,5	4,8
Stall current	I_0	A	10	10,3	2,02	2,79	4,23	4,8
Nominal torque	M_N	Nm	1,15	2	1,1	1,9	3	3,7
Nominal speed	n_N	min. ⁻¹	1500	1000	4500	3000	3000	3000
Nominal power	P_N	W	180	209	518	597	942	1162
Nominal current	I_N	A	11,3	11	2,9	3,06	4,31	4,5
Maximum torque	M_{max}	Nm	3,5	6,2	3,45	6,15	10,5	14,4
Maximum current	I_{max}	A	44	42	11,1	12,74	19,36	17,3
Max. speed mech.	n_{max}	min. ⁻¹	12000	12000	12000	12000	12000	12000
Torque constant	K_M	Nm/A	0,11	0,2	0,45	0,74	0,83	0,99
Voltage constant	K_E	V/1000 rpm	6,9	12	27,5	44,5	50	60
Motor poles	$2p$	-	10	10	10	10	10	10
Resistance 2 ph.	R_{2Ph}	Ω	0,34	0,41	5,4	5,38	2,81	2,5
Inductance 2 ph.	L_{2Ph}	mH	0,75	1	12	13,3	8,1	7,5
Inertia	J	kgcm ²	0,31	0,55	0,31	0,55	1,04	1,52
Mass without brake	m	kg	1,5	2	1,5	2	2,9	3,8
Mass with brake	m_{Br}	kg	2	2,5	2	2,5	3,4	4,3
Brake torque	M_{Br}	Nm	4,5	4,5	4,5	4,5	4,5	4,5

		VDC	560			
Magnets Nd-Fe-B			SMXN3-115	SMXN3-205	SMXN3-350	SMXN3-480
Stall torque	M_0	Nm	1,15	2,05	3,5	4,8
Stall current	I_0	A	1,78	2,25	2,38	2,8
Nominal torque	M_N	Nm	1,01	1,85	3	3,7
Nominal speed	n_N	min. ⁻¹	6000	4500	3000	3000
Nominal power	P_N	W	635	872	942	1162
Nominal current	I_N	A	1,99	2,56	2,42	2,6
Maximum torque	M_{max}	Nm	3,45	6,15	10,5	14,4
Maximum current	I_{max}	A	7,85	9,13	10,88	10,1
Max. speed mech.	n_{max}	min. ⁻¹	12000	12000	12000	12000
Torque constant	K_M	Nm/A	0,65	0,91	1,47	1,7
Voltage constant	K_E	V/1000 rpm	39	55	89	103
Motor poles	$2p$	-	10	10	10	10
Resistance 2 ph.	R_{2Ph}	Ω	10,71	8,4	8,89	7,5
Inductance 2 ph.	L_{2Ph}	mH	23	20,6	25,5	22,7
Inertia	J	kgcm ²	0,31	0,55	1,04	1,5
Mass without brake	m	kg	1,5	2	2,9	4,3
Mass with brake	m_{Br}	kg	2	2,5	3,4	4,5
Brake torque	M_{Br}	Nm	4,5	4,5	4,5	0,4

SERVOMOTORS SMXN3

1.15-4.8 Nm

DIMENSIONS

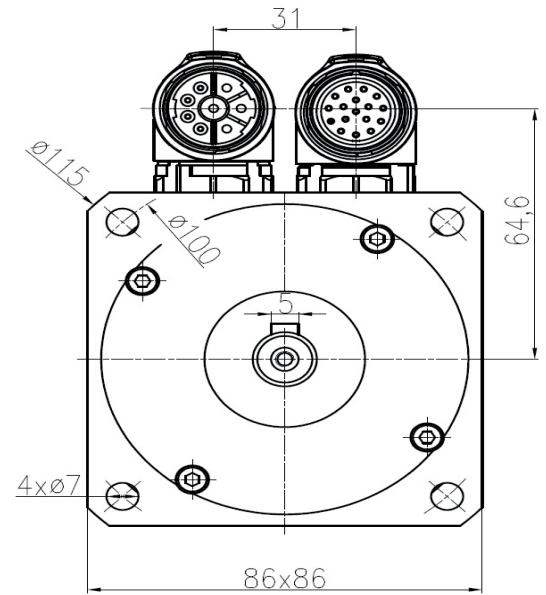
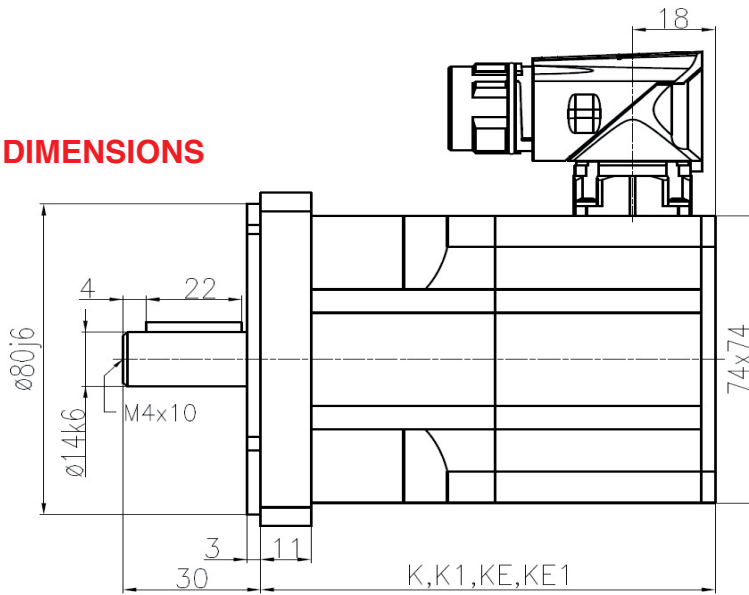

Type	K (Resolver)	K1 (Resolver+brake)	KE (EnDAT)	KE1 (EnDAT+brake)
SMXN3-115	82 mm	120 mm	123 mm	161 mm
SMXN3-205	100 mm	138 mm	141 mm	197 mm
SMXN3-350	136 mm	174 mm	177 mm	215 mm
SMXN3-480	172 mm	210 mm	213 mm	251 mm

Length of motor with Hiperface sensor is the same like length of motor with EnDat sensor. In some types of motor can be smaller.

Servomotors with one integrated connector

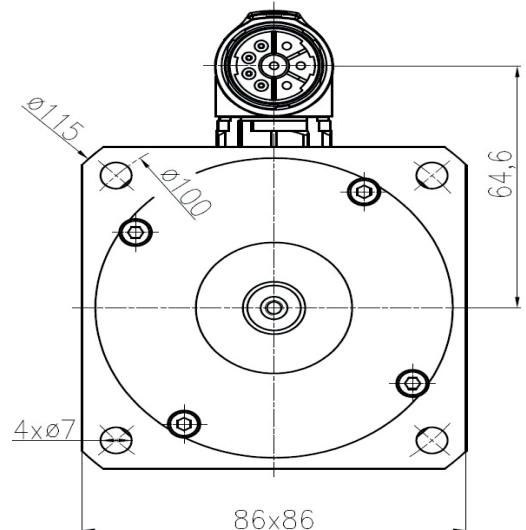
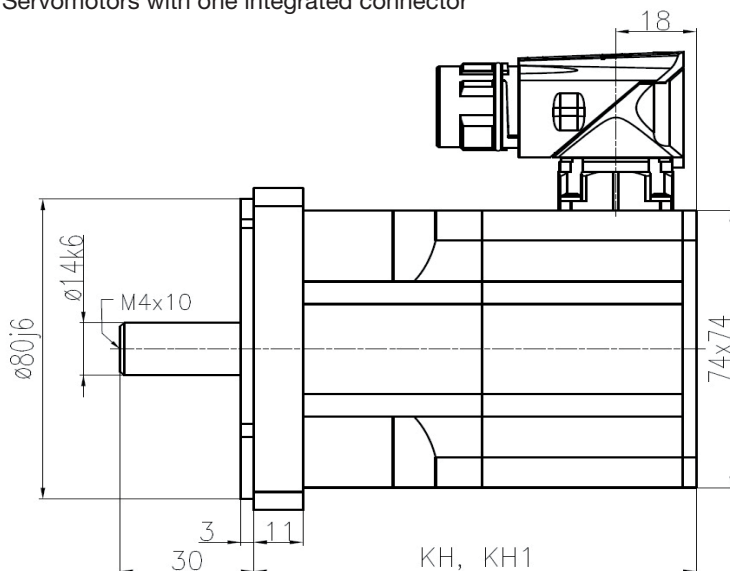

Type	KH (DSL)	KH1 (DSL+brake)
SMXN3-115	99 mm	144 mm
SMXN3-205	117 mm	162 mm
SMXN3-350	153 mm	198 mm
SMXN3-480	189 mm	234 mm

On request we can send you the technical parameters of the motors designed for different DC-Voltages or speed/torque characteristics. Other adaptations and modifications are possible.

SERVOMOTORS SMXN4

5.1-11.3 Nm

DIMENSIONS

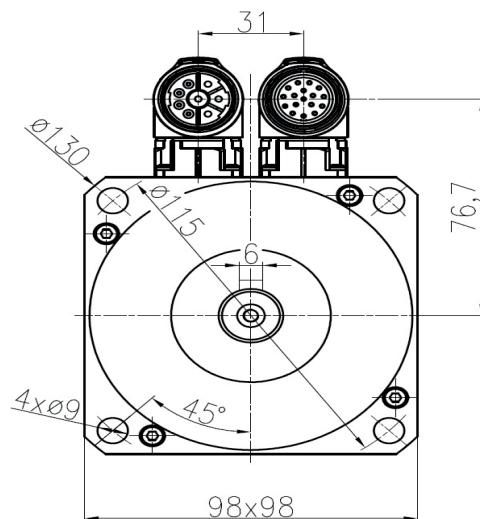
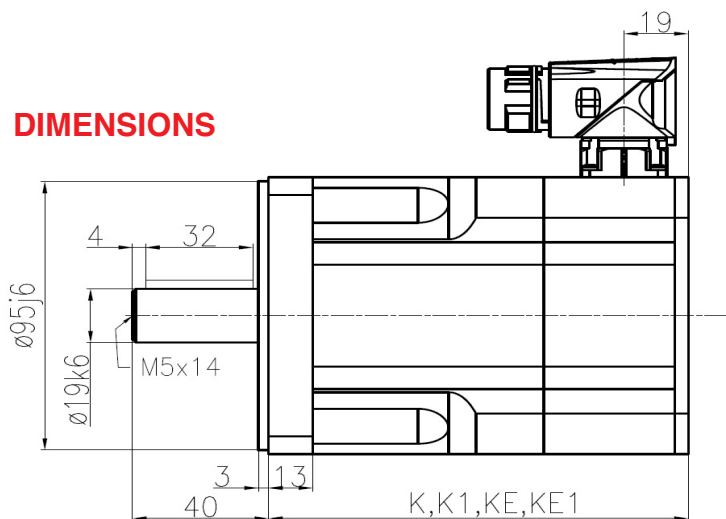

Type	K (Resolver)	K1 (Resolver+brake)	KE (EnDAT)	KE1 (EnDAT+brake)
SMXN4-510	113 mm	154 mm	150 mm	191 mm
SMXN4-750	143 mm	184 mm	180 mm	221 mm
SMXN4-960	173 mm	214 mm	210 mm	251 mm
SMXN4-1130	203 mm	244 mm	240 mm	281 mm

Length of motor with Hiperface sensor is the same like length of motor with EnDat sensor. In some types of motor can be smaller.

Servomotors with one integrated connector

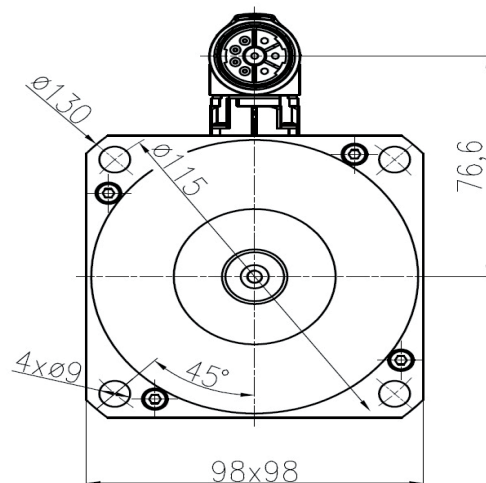
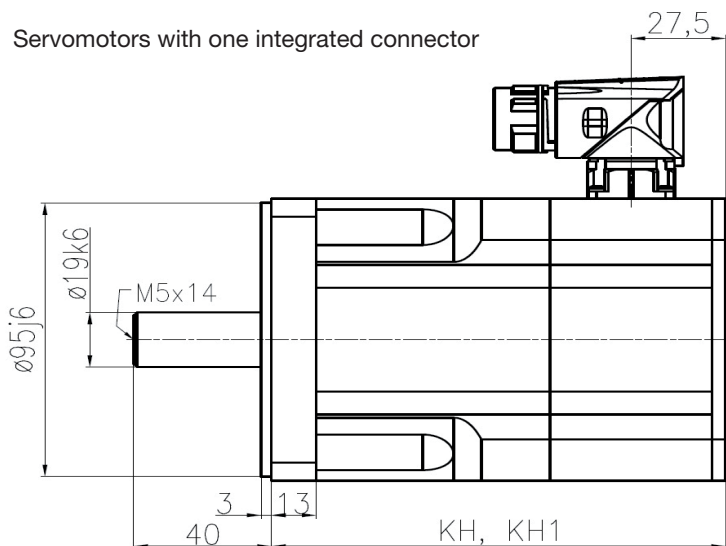

Type	KH (DSL)	KH1 (DSL+brake)
SMXN4-510	132 mm	182,5 mm
SMXN4-750	162 mm	212,5 mm
SMXN4-960	192 mm	242,5 mm
SMXN4-1130	222 mm	272,5 mm

On request we can send you the technical parameters of the motors designed for different DC-Voltages or speed/torque characteristics. Other adaptations and modifications are possible.

DIMENSIONS

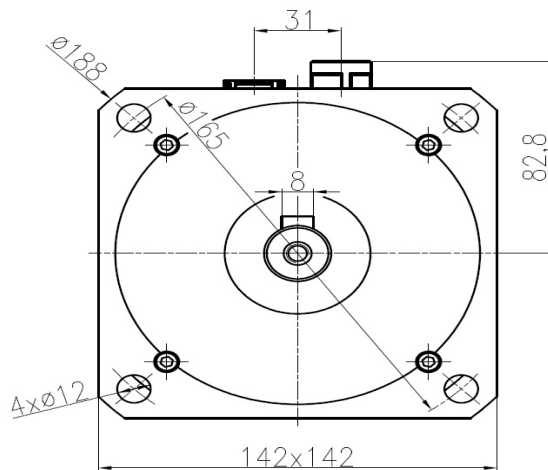
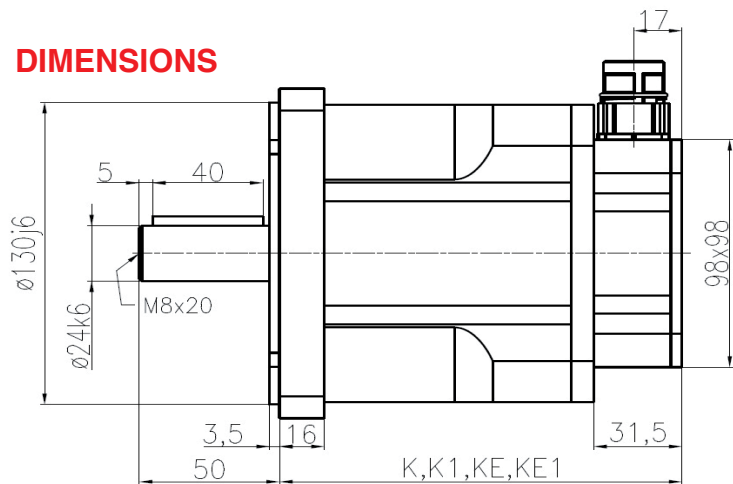

Type	K (Resolver)	K1 (Resolver+brake)	KE (EnDAT)	KE1 (EnDAT+brake)
SMXN5-1200	143,5 mm	179,5 mm	177 mm	222 mm
SMXN5-1600	173,5 mm	209,5 mm	207 mm	252 mm
SMXN5-2000	203,5 mm	239,5 mm	237 mm	282 mm
SMXN5-2400	233,5 mm	269,5 mm	267 mm	312 mm

Length of motor with Hiperface sensor is the same like length of motor with EnDat sensor. In some types of motor can be smaller.

Servomotors with one integrated connector

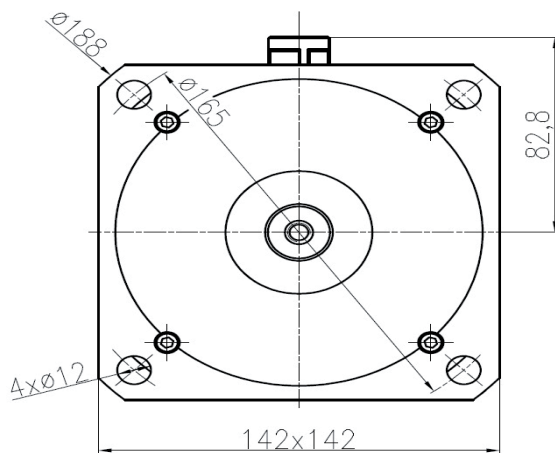
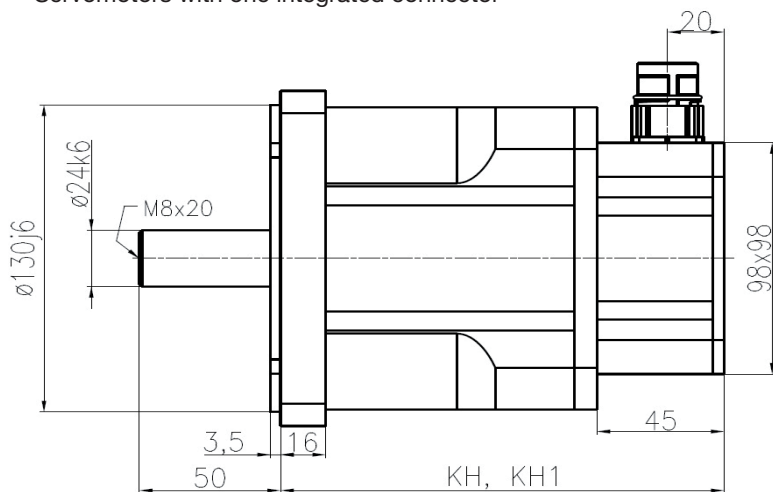

Type	KH (DSL)	KH1 (DSL+brake)
SMXN5-1200	157 mm	206 mm
SMXN5-1600	187 mm	236 mm
SMXN5-2000	217 mm	266 mm
SMXN5-2400	247 mm	296 mm

On request we can send you the technical parameters of the motors designed for different DC-Voltages or speed/torque characteristics. Other adaptations and modifications are possible.

DIMENSIONS

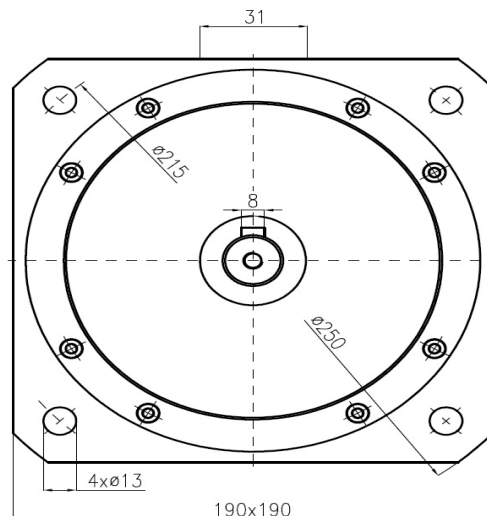
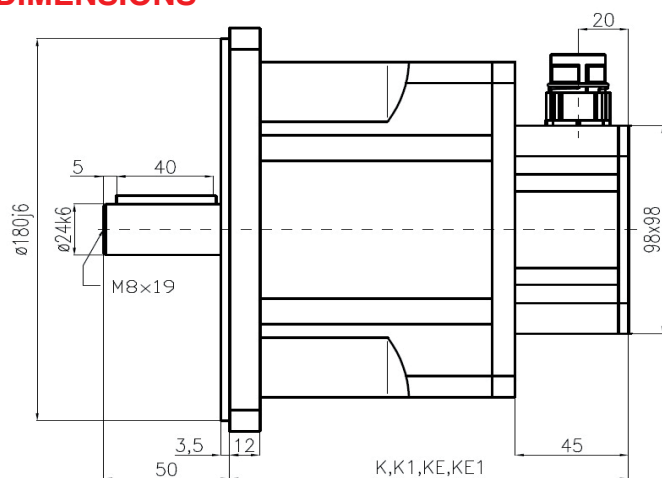

Type	K (Resolver)	K1 (Resolver+brake)	KE (EnDAT)	KE1 (EnDAT+brake)
SMXN6-1800	158 mm	222 mm	178 mm	242 mm
SMXN6-2400	183 mm	247 mm	203 mm	267 mm
SMXN6-3000	208 mm	272 mm	228 mm	292 mm
SMXN6-3800	233 mm	297 mm	253 mm	317 mm
SMXN6-4400	258 mm	322 mm	278 mm	342 mm

Length of motor with Hiperface sensor is the same like length of motor with EnDat sensor. In some types of motor can be smaller.

Servomotors with one integrated connector

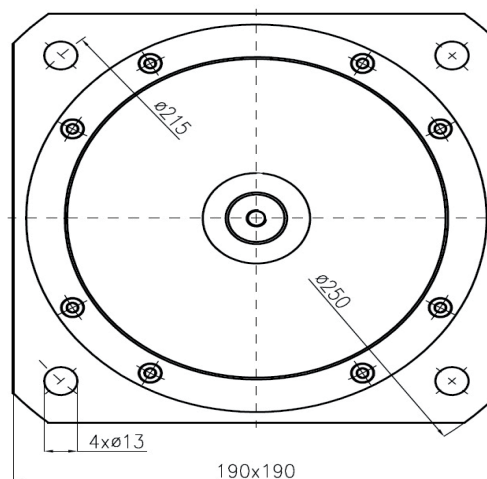
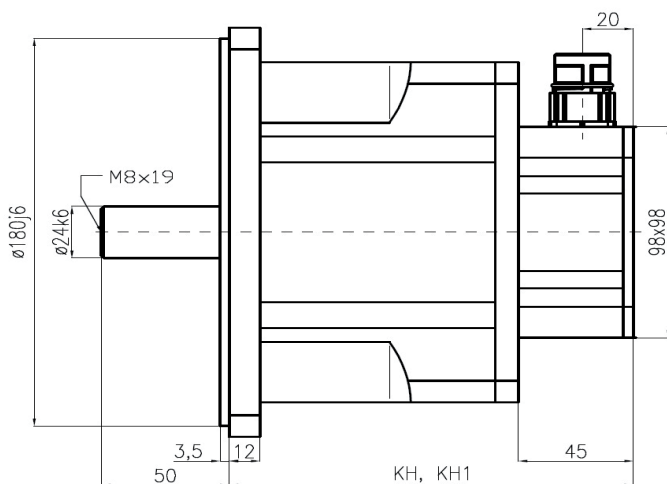

Type	KH (DSL)	KH1 (DSL+brake)
SMXN6-1800	158 mm	222 mm
SMXN6-2400	183 mm	247 mm
SMXN6-3000	208 mm	272 mm
SMXN6-3800	233 mm	297 mm
SMXN6-4400	258 mm	322 mm

On request we can send you the technical parameters of the motors designed for different DC-Voltages or speed/torque characteristics. Other adaptations and modifications are possible.

